

- 4 In1 Hidden HD Analog IR Camera

Contents

- 1) Cautions:
- 2) Product Introduction
 - 2.1 Camera Introduction
 - 2.2 Product Features
- 3) Menu Setup
- 4) Product Installation
 - 4.1 General Notes
 - 4.2 Installation Tools and Information
 - 4.3 Installation Method
 - 4.4 Setting the video output type
 - 4.5 Setting the Camera
 - 4.6 Connection
 - 4.7 OSD Control
- 5) Technical Specification

1 Cautions:

1. To reduce the risk of electric shock, do not open the camera or perform internal maintenance by yourself. Please consult a professional service person if needed.
2. To prevent fire or electrical shock hazard, make sure that the input voltage, current, polarity and operating temperature meet the requirements of the camera.
3. Please note the operating temperature and environmental limits of the camera. Do not install in higher/lower temperatures than $-20^{\circ}\text{C}\sim+50^{\circ}\text{C}$ ($-4^{\circ}\text{F}\sim122^{\circ}\text{F}$). These cameras are not waterproof! Minimize dust and moisture erosion, otherwise camera would be damaged.
4. Avoid directing the camera to sunlight while powered on, otherwise the sensor will be damaged.
5. Do not touch the sensor surface. If any foreign objects exists use a cotton swab or lens paper to clean. if it is difficult to remove, use a neutral detergent diluted with water.

6. In order to ensure required image quality, the power and video cables shouldn't be too long. Please follow general AHD/Analog specifications for cables types and lengths.

7. Please install the camera on a stable surface in order to prevent the camera from falling, .

8. The camera should not be placed near a radiator or heating source.

Package Contents:

- Camera
- Bracket
- Video+Power Balun
- Installation Accessories
- User Manual

2 Product Introduction

2.1 Camera Introduction

PROVISION-ISR's new series of cameras have adopted a high performance CMOS image sensor which provides HD resolution and supports high resolution video output. The cameras support video transmission distance of around 400M base on Rg59 standard coaxial cable. This series can support AHD/TVI/CVI/CVBS 960H analog output.

2.2 Product Features

- HD analog over network cable
- DIP Switch
- Auto Day/Night (ICR)
- Auto Defog, HBLC
- 2D/3D NR
- Motion Detection, Privacy Mask
- AHD/TVI/CVI/CVBS Signal Selectable (by jumper)

3 Menu Setup

AHD/TVI: Click on “Iris+” button from the DVR's PTZ interface to call the OSD Menu. Use the PTZ interface to scroll through the menu and “Iris+” to confirm.

CVI: Click “▶” button from the DVR's PTZ interface, then click “” and press “Enter” to call the OSD Menu.

4 Product Installation

4.1 General Notes

1. Make sure the unit is powered off before installation.
2. Check that power supply voltage complies with the camera requirement to prevent damage to the camera.
3. The installation and maintenance of this product should be done by a professional. Please do not remove or modify the camera in any way.

4.2 Installation Tools and Information:

Crefully read these instructions before installation. It is highly advisable to prepare the following tools: A Phillips-head screwdriver, multi-meter, cutter, needle nose pliers, measuring tape, pencil, drilling machine (if installed on concrete).

4.3 Installation Method:

1. Check the camera for any external damage.
2. Mount the camera bracket:
 - ① For cement wall, install the expansion screws, and then mount the bracket.
 - ② For wooden wall use self-tapping screws to mount.

4.4 Setting the video output type:

The camera supports AHD/TVI/CVI/CBVS video output, And PAL/NTSC system is switable by setting a DIP switch on the cable as illustrated:

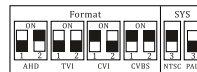

The Default Setting is PAL + AHD.

4.5. Setting the camera:

Adjust the lens position so it aims at the main monitoring point and gives a clear picture.

Note:
The wall needs to bear at least 3 times the weight of the camera.

4.6 Connection

Connection as shown in the figure below:

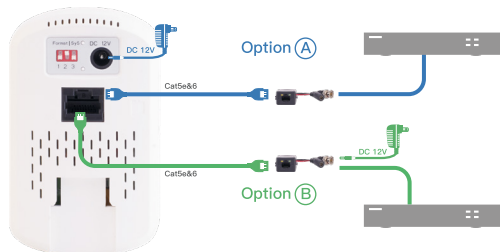

Option A: Connect the supplied balun to the DVR video input terminal. Connect a network cable (Cat5e/6) between the balun and the camera. provide the camera local 12VDC power (Not supplied).

Option B: Connect the supplied balun to the DVR video input terminal and local 12VDC power (Not supplied). Connect a network cable (Cat5e/6) between the balun and the camera.

***Important Notes:** A. 12V1A power adapter is recommended to avoid interface/power problems.

B. When using the supplied balun, the maximum power and signal transmission distance is no more than 100M by cat5e/cat6 cable. For distances over 100M, please use local DC12V1A power source.

The actual working distance may be affected by the cable quality, length and other environmental influences.

4.7 OSD Control

The OSD control is available by CoC (Control over Coax). If your AHD/TVI/CVI DVR supports this function*, use the DVR's PTZ interface to press on "Iris+" or " " to open the OSD menu.

Navigate through the OSD menu using the PTZ direction arrows.

OSD Menu List

Main Menu		Second Menu		Third Menu	
LENS	DC	Indoor			
		Outdoor	↓	MIN_SHU	MAX_SHU
	Manual				
EXPOSURE	↓	SHUTTER	AUTO 1/25s- 1/5000s X2-X30		
		AGC	0-15		
		SENS-UP	AUTO	SENS-UP	x2-x30
		BRIGHTNESS	1-100		
		D-DWR	OFF		
			AUTO		
			ON		
		DEFOG	OFF		
AUTO	POS/SIZE		GRADATION	DEFAULT	

BACKLIGHT	OFF				
	BLC	LEVEL			
		AREA			
		DEFAULT			
	HSBLC	SELECT	AREA1-4		
		DISPLAY	OFF		
			ON	POS/SIZE	
		BLACK MASK	ON/OFF		
		LEVEL	1-100		
		MODE	ALL DAY		
NIGHT			AGC LEVEL	0-255	
DEFAULT					
WHITE BAL	ATW				
	AWB				
	MANUAL	BLUE	1-100		
		RED	1-100		
	OUTDOOR				
	INDOOR				
	AWC-SET				
DAY/NIGHT	AUTO				
	COLOR				
	B/W				
	EXT	↓	D-N(DELAY)	0-60	
		N-D(DELAY)	0-60		

NR	↓	2DNR	LOW/MID/ HIGH			
		3DNR	LOW/MID/ HIGH			
SPECIAL	↓	CAM TITLE				
		D-EFFECT	↓	FREEZE		
				MIRROR	OFF	
				ROTATION		
				V-FLIP		
				MIRROR		
		NEG IMAGE				
		MOTION	SELECT	AREA1-4		
			DISPLAY	ON/OFF		
			SENSITIVITY	0-100		
			ALARM	ON/OFF		
		PRIVACY	SELECT	AREA1-4		
			COLOR	W/R/B/G		
		TRANS	0,25-1,0			
		LANGUAGE		12 choices		
DEFECT	↓	WHITE	ON/OFF			
		BLACK	ON/OFF			
RS485						
ADJUST	↓	SHARPNESS	↓	LEVEL	1-10	
				VALUE	0-255	
		VIDEO OUT		PAL/NTSC		
		MONITOR		CRT/LCD and LSC		
EXIT		SAVE&END				

5 Specifications:

4 in 1 Pro camera (1080P)

IV-390A37-UTP

Model	IV-390A37-UTP
Image Sensor	1/3" 2MP CMOS Sensor
Effective Pixels	1984(H)×1225(V)
Scanning System	Progressive
Resolution	Digital:1920×1080P, Analog:960H
Min. Illumination	0.01Lux / (0Lux IR On)
Day & Night	EXT, Color, B&W, AUTO
IR LED	36pcs (10m)
OSD Menu	Available by CoC Only
CoC Support	Yes
Backlight Compensation	OFF/BLC/HSBLC
S/N Ratio	≥80dB (AGC Off)
White Balance	AWB, ATW, AWC (Push), Indoor, Outdoor, Manual
Noise Reduce	3D-DNR (For Analog HD), 2D-DNR (For Analog)
Video Output	AHD/TVI/CVI/CVBS (Signal Selectable by DIP switch)
System Format	PAL/NTSC (System Selectable by DIP switch)
Defog	Off/On
Privacy Mask	Off/On (4 Areas)
Motion Detection	Off/On (4 Areas)
D-Effect	Freeze, Mirror, Negative Image
Lens	3.6mm
Power	DC12V±10%, ~310mA
Operation temp.	-20°C~+50°C (-4°F~122°F)
Dimension	104*70.8*93.2mm
Net Weight	269g